

# operator's manual

**INSTALLER: To be removed for use by the occupant**

 **AMERICH<sup>®</sup>**

# operating instructions

## Airbath®

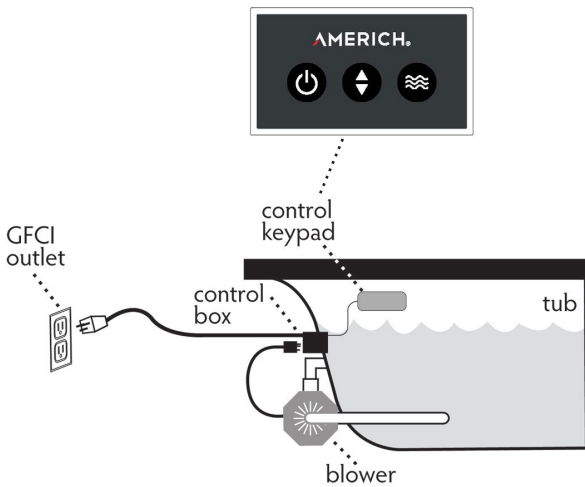

Always use dedicated outlets for each power supply.\*\*



### On/Off Key

- 1st Press: The blower starts at 50%
- 2nd Press: The blower stops



### System Speed

- 1st Press: Press and hold to increase the blower speed, release pressure at the desired speed.
- 2nd Press: Press and hold to decrease the blower speed, release pressure of the desired speed.



### Wave Mode

- 1st Press: Wave - Speed will vary gradually from maximum to minimum.
- 2nd Press: Pulse - Speed will go directly to minimum and then straight back to maximum.
- 3rd Press: Returns to maximum speed.

### Water Level Sensor

If water falls below water level sensor while blower is on, an automatic purge will initiate in thirty minutes to dry the air channels.

### Automatic Purge

Thirty minutes after the water falls below the water level sensor the blower will start again for a one-minute purge cycle allowing piping to thoroughly dry.

## AIRBATH® + LIGHT

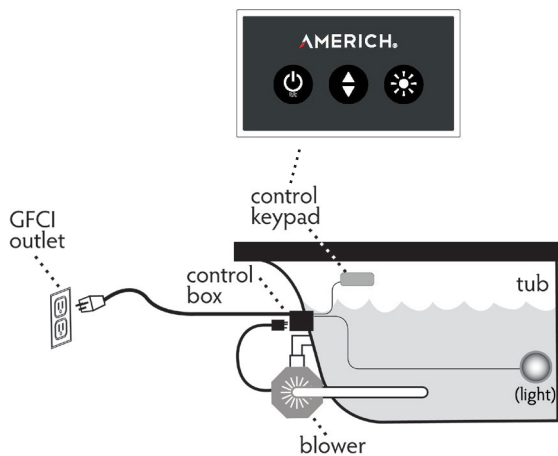

Always use dedicated outlets for each power supply.\*\*



### On/Off Key

- 1st Press: The blower starts at 50%.
- 2nd Press: The blower stops.
- While the blower functions press and hold
- 3 sec.: Wave - Speed will vary gradually from maximum to minimum
- 6 sec.: Pulse - Speed will go directly to minimum and then straight back to maximum.



### System Speed

- 1st Press: Press and hold to increase the pump speed, release pressure at the desired speed.
- 2nd Press: Press and hold to decrease the pump speed, release pressure of the desired speed.



### Chromotherapy

- 1st Press: Auxiliary equipment ON > White
- 2nd Press: Slow rainbow cycle
- 3rd Press: Fast rainbow cycle
- 4th Press: Turquoise, Blue, Magenta, Red, Orange, Yellow, Green
- Return to slow rainbow cycle
- Press and Hold 1 sec.: Auxiliary equipment OFF

### Automatic Purge

\*(only available with models equipped with Airbath® )

Thirty minutes after the water falls below the water level sensor the blower will start again for a one-minute purge cycle allowing piping to thoroughly dry.

\*\*Note: Blower hose for AirBath Systems is shipped loose:

- 1) Remove red caps from blower and check valve.
- 2) Attached grey hose to blower and check valve.
- 3) Tighten clamp around each end.

# operating instructions

## BUILDER SERIES

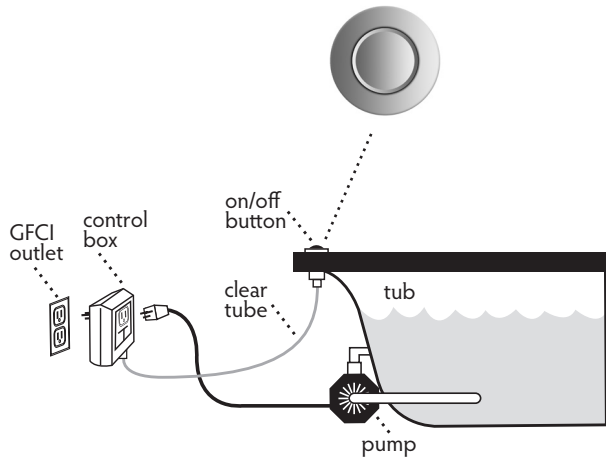

Always use dedicated outlets for each power supply.\*\*

The Builder Series whirlpool is equipped with an On/Off Button (fill tub until the highest jet is covered by at least 2" of water. Do not run pump without water in the tub.)

1. Press the Button to start the pump.
2. Press a second time to stop the pump. The Control Box is manufactured with a 10 minute timer that will turn off the unit automatically. To continue your bath, simply push the Button to repeat the cycle.

Note: If OPTIONAL built in water level sensor is installed on your tub, fill the tub with water until the water level sensor pad is covered. Now you can press the Button to start the pump.

## LUXURY SERIES

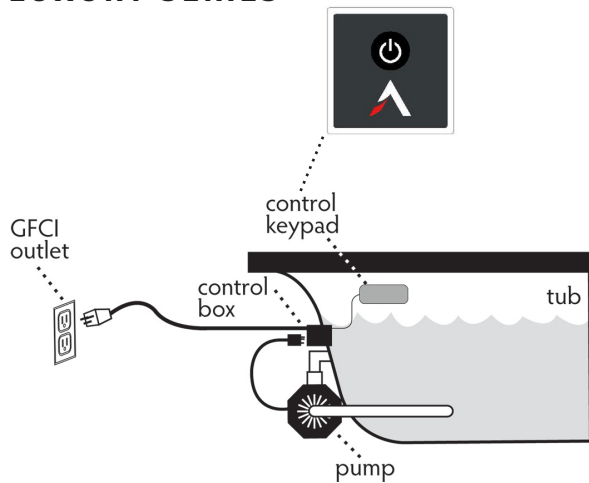

Always use dedicated outlets for each power supply.\*\*



1. Press the Button to start the pump.
2. Press a second time to stop the pump. The Control Box is manufactured with a 20 minute timer that will turn off the unit automatically. To continue your bath, simply push the Button to repeat the cycle.

### Water Level Sensor

If water falls below water level sensor while pump is on, the system will turn OFF.

## PLATINUM SERIES OR LUXURY SERIES + LIGHT

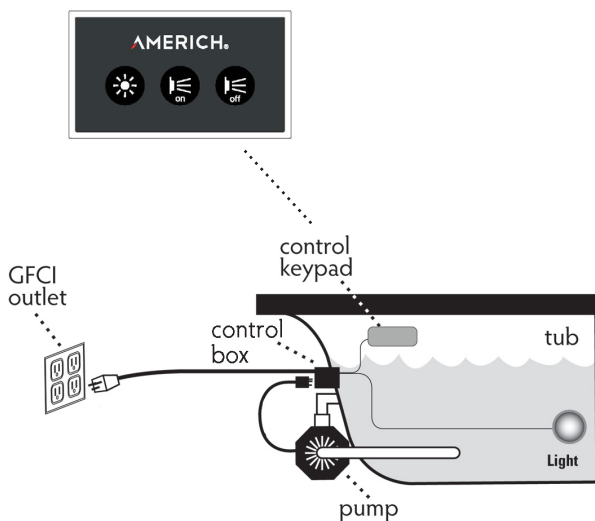

Always use dedicated outlets for each power supply.\*\*



Starts pump



Stops Pump



### Chromotherapy

- 1st Press: Auxiliary equipment ON > White
- 2nd Press: Slow rainbow cycle
- 3rd Press: Fast rainbow cycle
- 4th Press: Turquoise, Blue, Magenta, Red, Orange, Yellow, Green
- Return to slow rainbow cycle
- Press and Hold 1 sec.: Auxiliary equipment OFF

### Water Level Sensor

If water falls below water level sensor while blower is on, the system will turn OFF.

# operating instructions

## COMBO SERIES + LIGHT

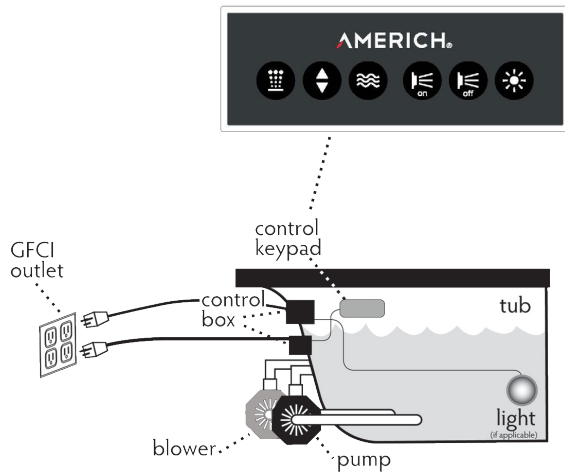

Always use dedicated outlets for each power supply.\*\*



### Blower On/Off

- 1st Press: The blower starts at 50%
- 2nd Press: The blower stops.



### Blower System Speed

- 1st Press: Press and hold to increase the blower speed, release pressure at the desired speed.
- 2nd Press: Press and hold to decrease the blower speed, release pressure at the desired speed.



### Blower Wave Mode

- 1st Press: Wave - Speed will vary gradually from maximum to minimum.
- 2nd Press: Pulse - Speed will go directly to minimum and then straight back to maximum.
- 3rd Press: Returns to maximum speed.

### Pump On/Off



The pump starts



The pump stops



### Chromotherapy

- 1st Press: Auxiliary equipment ON > White
- 2nd Press: Slow rainbow cycle
- 3rd Press: Fast rainbow cycle
- 4th Press: Turquoise, Blue, Magenta, Red, Orange, Yellow, Green
- Return to slow rainbow cycle
- Press and Hold 1 sec.: Auxiliary equipment OFF

### Water Level Sensor

The system will turn OFF if the water level falls below the water level sensor while pump is on.

If water falls below water level sensor while blower is on, an automatic purge will initiate in thirty minutes to dry the air channels.

### Automatic Purge

Thirty minutes after the water falls below the water level sensor the blower will start again for a one-minute purge cycle allowing piping to thoroughly dry.

Each system will automatically stop after 20 minutes.

\*\*Note: Blower hose for AirBath Systems is shipped loose:

- 1) Remove red caps from blower and check valve.
- 2) Attached grey hose to blower and check valve.
- 3) Tighten clamp around each end.

**IMPORTANT:** Keep these instructions with the Americh Installation Instructions. These operating instructions are for units with systems. All installation, warnings, warranties, and other such information can be found in the Americh Installation Instructions. Go to [www.americh.com](http://www.americh.com) for additional copies.

Manufacturer recommends the use of Jet Fresh® or a similar system cleaning solution to maintain your whirlpool or Airbath® System.

**Always check [www.americh.com](http://www.americh.com) for the most updated installation instructions.**

### in compliance with

- ANSI Z124.1 - 1995
- ANSI A112.19.7 - 1987
- ANSI A112.19.8 - 1987
- City of Los Angeles
- M980036 and M820132

listed by

