



operator's manual

Vibro Sonic Massage (V S M)[®]

INSTALLER: To be removed for use by the occupant

Always check www.americh.com for the most updated operating instructions.

CAREFULLY READ AND FOLLOW ALL INSTRUCTIONS before attempting to operate your whirlpool or Airbath[®] Bathtub.

IMPORTANT SAFETY INSTRUCTIONS: pertaining to a risk of fire, electric shock, or injury to persons

Warning: Whirlpool bathtubs utilize acrylic and fiberglass materials (which are inherently slippery surfaces), electricity, water, air pressure and suction. The following basic safety precautions should always be followed when using your bathtub.

READ AND SAVE THESE INSTRUCTIONS

ELECTRICAL REQUIREMENTS

Manufacturer recommends a dedicated 20 amp circuit breaker for each power cord supplied on your whirlpool bathtub. **WARNING** - When using electrical products, basic precautions should always be followed, including the following:

1. **DANGER: Risk of electric shock.** Connect only to a supply circuit protected by a Class A ground-fault circuit-interrupter (GFCI). Test on a routine basis.
2. Grounding is required. The unit should be installed by a qualified service representative and grounded.
3. (For built-in and custom units) install to permit access for servicing.
4. Supply 110 Volt electrical outlet. This circuit must be protected by a ground fault circuit interrupter (GFCI.)

5. Plug supply cord(s) into electrical outlet.
6. To test the GFCI, do the following:
 - a. Push the test button;
 - b. Check to see that power has been interrupted;
 - c. Push the reset button;
 - d. Check to see that power has been restored.

If the GFCI does not operate properly during the test, there is a ground current flowing indicating the risk of electric shock. Do not use this unit. Disconnect the unit and have the problem corrected by a qualified service representative before using.

Refer to Operating Instructions for system operations and wiring diagrams.

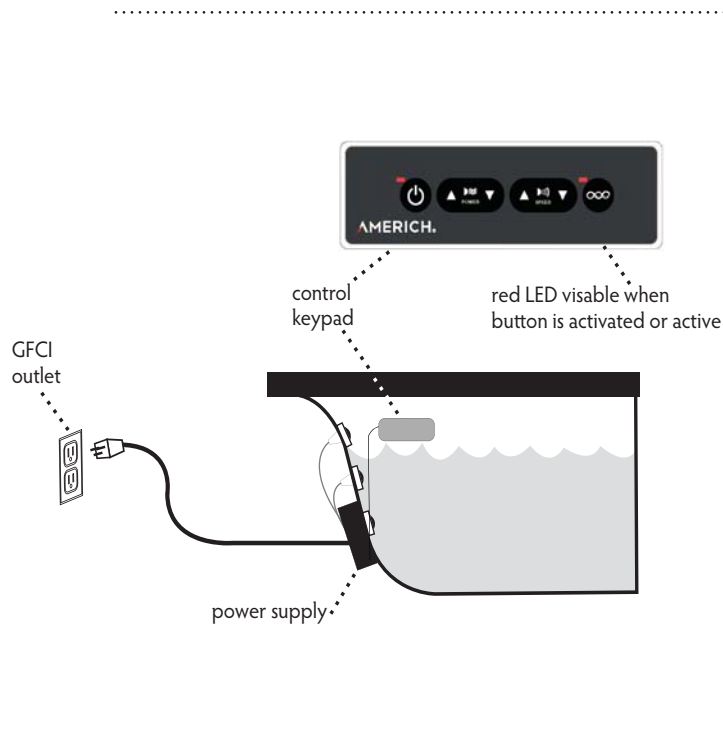

Vibro Sonic Massage On/Off

1st Press: The module starts at 50% in vibration mode
2nd Press: The modules stops.



Pulsation Control

Press up or down arrows to increase or decrease pulsation power. The Vibro Sonic System has five levels of pulsation control.



Vibration Control

Press up or down arrows to increase or decrease vibration speed. The Vibro Sonic System has five levels of vibration control.



Sequence Modes

The Vibro Sonic System offers 3 different Shiatsu massage sequences. Push the Sequence Mode button to cycle through patterns.

figure 1. Massage Module



figure 2 - Keypad

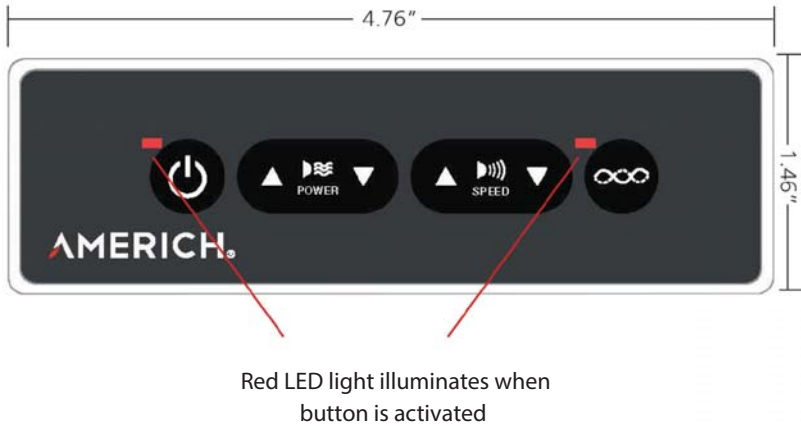
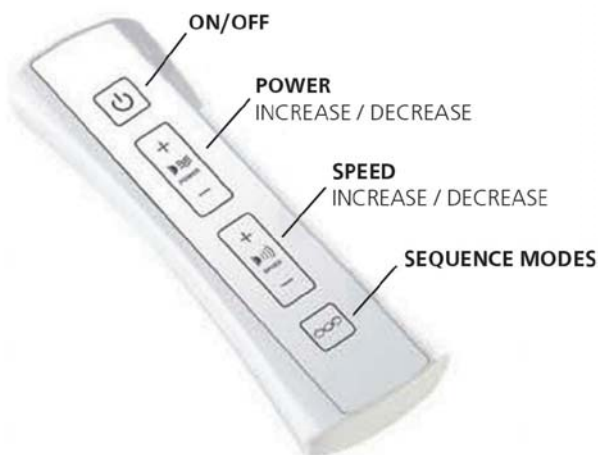

figure 3 - Optional Remote Control



COLOR OPTIONS FOR TRIM RING:
WH - White
BK - Black
PC - Chrome

VIBRO SONIC MASSAGE SYSTEM:
The standard VSM system includes a tub side mounted control pad (figure 2). An optional remote control can be ordered if desired (figure 3)

CLEANING:
The silicone massage module can be cleaned using liquid soap and hot water.

Rinse thoroughly with warm water and dry with a soft cloth.

The VSM system can be used with or without water in the tub.

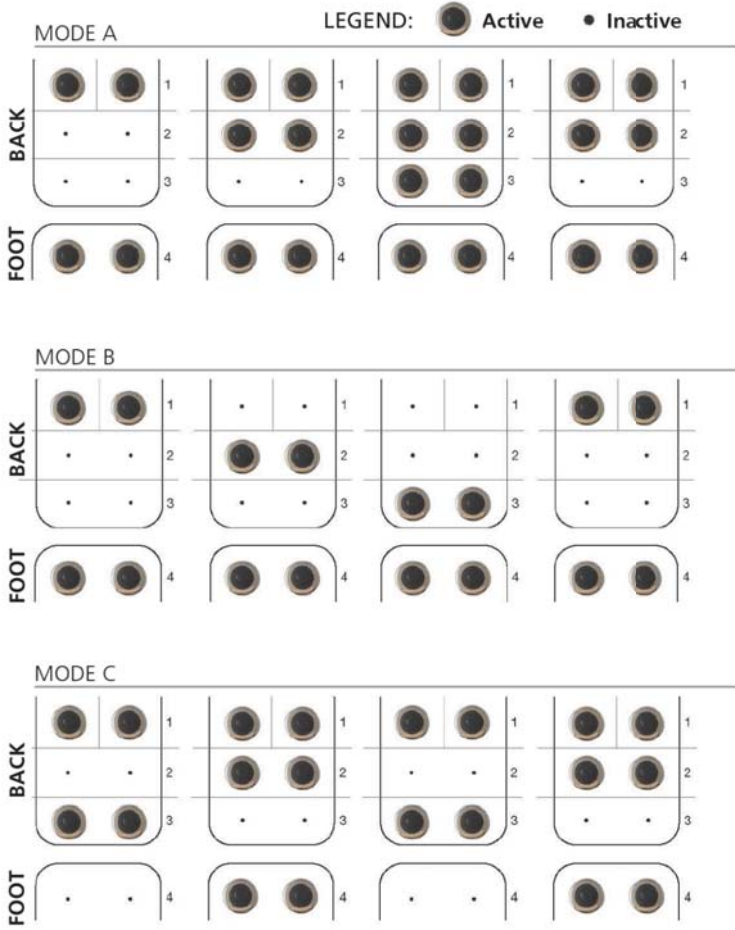
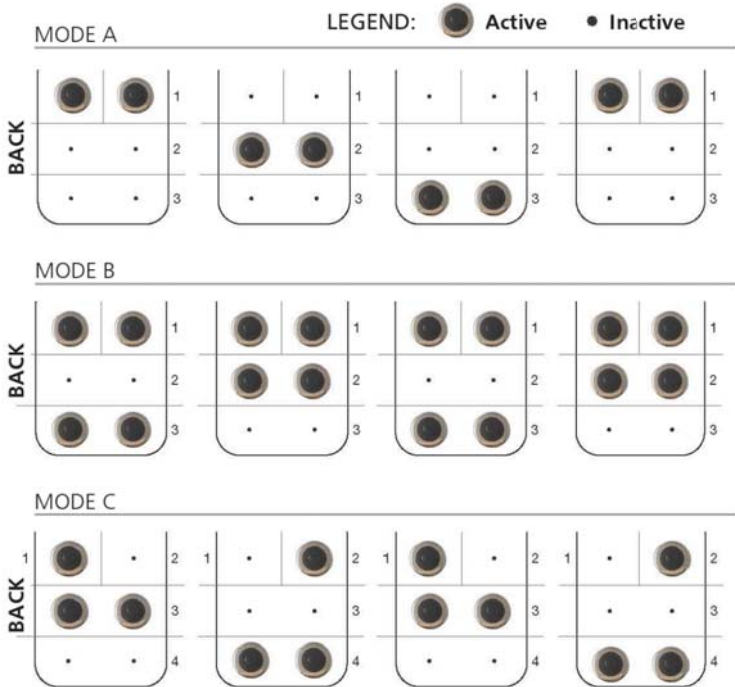

VSM Systems

6 Module VSM (BACK ONLY)



8 Module VSM (BACK & FOOT)



Please note that if an 8 module VSM system is ordered on a tub with a whirlpool system that has jets on the same end as the VSM foot jets, the whirlpool jets will be removed in order to accommodate the VSM foot jets.